

**PLEASE READ AND SAVE THIS  
USE AND CARE INSTRUCTIONS**

© 2009 Daka Research Inc. All rights reserved.  
[www.onetouchproducts.com](http://www.onetouchproducts.com)

Patented and Patent Pending  
Printed in China

Rev.160209

**ONE·TOUCH™**

[www.ONETOUCHPRODUCTS.com](http://www.ONETOUCHPRODUCTS.com)

## **AUTOMATIC CAN OPENER**



**USER MANUAL**

Model no.: KC08

## CAUTION

- Read all instructions carefully before using your Can Opener.
- Close supervision is necessary when your Can Opener is used by or near children.
- **DO NOT** open pressurized (aerosol-type) cans.
- **DO NOT** open cans of flammable liquids such as lighter fluids.
- Make sure the motor has stopped completely before taking off the bottom cover for battery replacement.
- During battery replacement **DO NOT** press the switches on the bottom and the button on the top of your Can Opener to avoid turning the unit on.
- Before cutter cleaning, remove batteries to avoid accidentally turning the unit ON.
- Avoid contact with moving parts. Keep hands, hair, jewelry, clothing etc away from moving parts during operation to prevent injury, and/or damage to the Can Opener.
- To maintain your Can Opener at its optimal condition, **DO NOT** immerse it in water or any other liquids.
- **DO NOT** try to adjust or remove the cutter screw.
- **NOT** suitable for dish washer.

## Parts

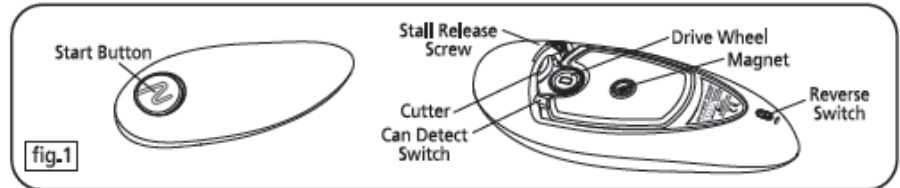

## Getting Started

Slide back the bottom cover, to remove and install 2 AA alkaline or rechargeable batteries according to the polarity (+/-) instruction. Replace the bottom cover after the batteries have been installed (see fig.2). Always replace both batteries at once and never mix old and new batteries or batteries of different types.

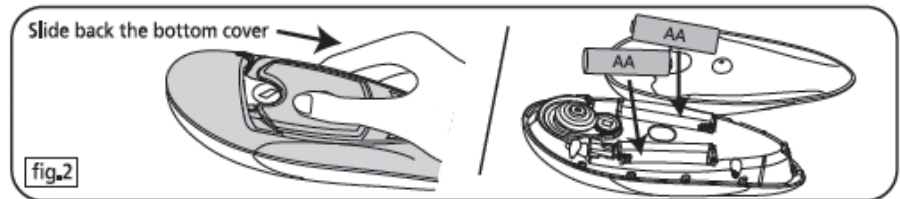

## USING THE "ONE TOUCH" CAN OPENER

1. Place your Can Opener on top of the can with its rim positioned in the groove at the bottom of the Can Opener (see fig.3).

**NOTE:**

The cutter will not operate unless it is positioned correctly on the rim of the can.

To open the cans with tab, turn them upside-down, so that the Can Opener can work on the lid without tab.

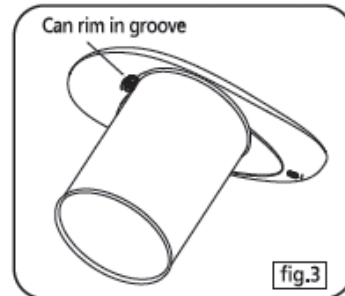

2. With the can on a flat surface, press the Start button for about one second and release it once the Can Opener starts to cut the can (see fig.4). After cutting, the Can Opener will stop automatically. (see fig.5)

**NOTE:**

The maximum can size that can be fully cut in one go is 90mm (3.5") diameter. If the lid of a bigger can, needs to be completely removed, press the Start Button again and let go once it resumes cutting. Once again, the Can Opener will stop automatically after cutting.

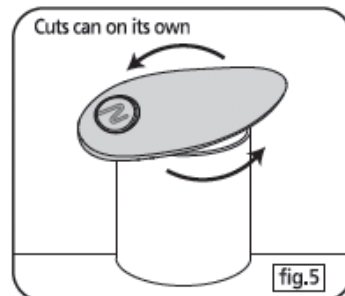
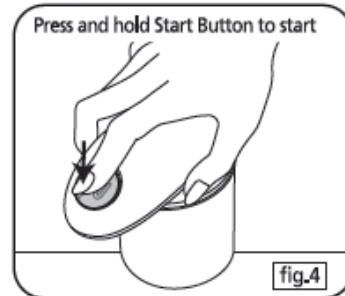

3. When the cutting has completed, lift the Can Opener off the can. A magnet on the Can Opener will pick up the lid as well for convenience (see fig.6).

**NOTE:**

There is functional sharp edge on the round cutter, and should be treated with care.

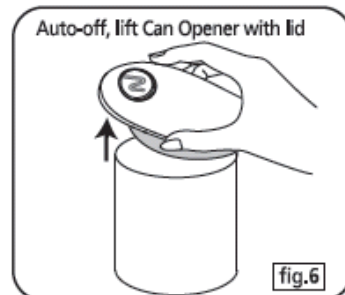

## Care and Maintenance

1. If the Can Opener slows during cutting, this may indicate low battery level and the batteries should be replaced. If the Can Opener stops during operation, see "Trouble Shooting" below.
2. To clean the cutter, first slide off the bottom cover and remove the batteries as a safety precaution. Wipe the cutter with a damp cloth or a sponge, using a mild non-abrasive cleaner, followed with a clean, dry cloth to dry it completely.

## Trouble Shooting

1. If the Can Opener is jammed due to low battery level or a deformed can rim, press the small button at the rear of the Can Opener to activate the reverse so that the can is released, keep the Reverse Switch depressed until the Can Opener stops (see fig.7).

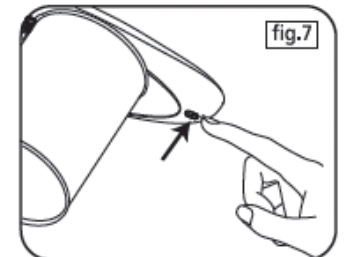

2. If batteries are depleted the Can Opener may not be released by pressing the Reverse Switch. In this case, insert a 4 or 5 mm Crosshead (or flat) screwdriver into the Stall Release Screw, and slowly turn it in a anti-clockwise direction as viewed underneath (as arrow) until the can is released (see fig.8).

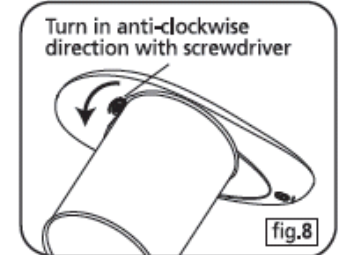

**NOTE:** After replacing the batteries following use of the Stall Release Switch, press and hold the Reverse Switch and Can Detect Switch (see fig.1) together until the Can Opener resets to its start position. Keep your fingers away from the Cutter and Drive Wheel to prevent injury.

3. Cans with heavy seams, odd shapes, or uneven rims may stall the Can Opener. If this happens, follow above procedure to release the can. Start the cutting action just beyond any minor bump or dent in a can.

**NOTE:** The Can Opener will not open rimless cans or cans with odd corners.

## Technical Specifications

Operate voltage: DC2.4-3V

Battery: 2 x AA alkaline or rechargeable batteries

Maximum can cutting size in one cycle: diameter 90mm (3.5") (preferred)